

# Unprotected "Bare" Fluted Substrate



## UD19 - "Bare Slotted" Parallel Offset with Flute Cover/Caulk

Joint Movement Capabilities (MC) / Profile Series refer to UL Listing: [HW-D-0633](#)

**1/2" MC** - (BST) (BSTE)

**Caulk** - A/D Fire EGS Nelson Hilti STI Tremco USG Rectorseal

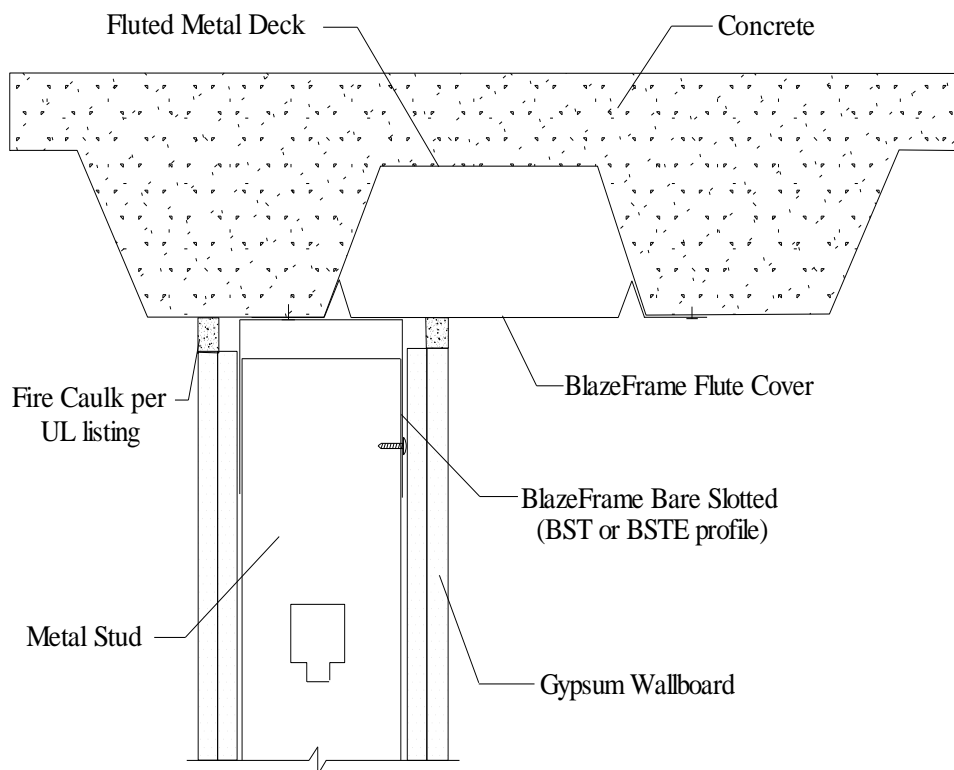

1. Max Installed Gap = 1"
2. Movement Capability = 25% of Nominal Gap
3. Attach to substrate with approved fastener max 24" O.C or per E.O.R.
4. Do not screw drywall or stud to BlazeFrame "BST" profile
5. "Positive Attachment" fasten framing fastener in center of slot (min. one side)
6. Drywall fasteners 1" below BlazeFrame profile

### UL, ASTM & Code Standards

UL2079, E814, E1966, ULC S115-M95  
A1003, A653, A924, C645, C754, C955  
AISI 2004 NAS  
2006 & 2009 IBC  
2007 CBC

### Leed Points

MR 2.1 & 2.2 - Construction Waste: up to 2 pts  
MR 4.1 & 4.2 - Recycled Content : up to 2 pts  
MR 5.1 & 5.2 - Regional Proximity  
EQ 4.1 - Low Emitting Materials  
EQ 9 - Enhanced Acoustical

Phone: (425) 869-2811 Fax: (425) 869-2300