

Vertical & Miscellaneous



VM19 - Underneath Open Web Truss Bypass "Span Framing"

Joint Movement Capabilities (MC) / Profile Series based on UL Listing: [HW-D-0543](#)

3/4" MC - (Stock Series) 1" MC - ("W" Series) 1 1/2" MC - ("X" Series)

2" MC - ("Z" Series) 3" MC - ("Y" Series)

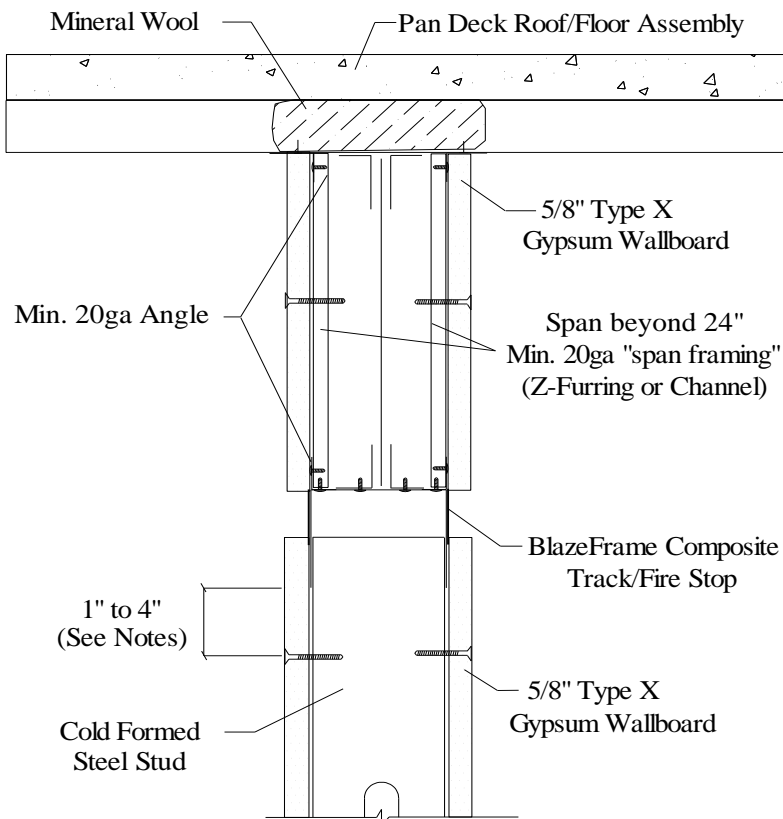

1. Installed Gap (compression only) = movement capability (MC) of profile
2. Installed Gap (compress + extension) = 1/2 movement capability (MC) of profile
3. Attach to substrate with approved fastener max 24" O/C or per E.O.R.
4. Attach metal "span framing" to upper end of stud and slotted ISAF profile
5. Do not screw drywall to BlazeFrame profile
6. Drywall fasteners min 1" to 4" below BlazeFrame ISAF to accommodate MC

UL, ASTM & Code Standards

UL2079, E814, E1966, ULC S115-M95
A1003, A653, A924, C645, C754, C955
AISI 2004 NAS
2006 & 2009 IBC
2007 CBC

Lead Points

MR 2.1 & 2.2 - Construction Waste: up to 2 pts
MR 4.1 & 4.2 - Recycled Content : up to 2 pts
MR 5.1 & 5.2 - Regional Proximity
EQ 4.1 - Low Emitting Materials
EQ 9 - Enhanced Acoustical

Phone: (425) 869-2811 Fax: (425) 869-2300